

## Theater Commons at Seattle Center

Opening May 2010

Seattle Center is partnering with Seattle Repertory Theatre and Intiman Theatre to turn a small parking area located between their two buildings into a lush, landscaped space. It will be called Theater Commons at Seattle Center.

Theater Commons will transform the one and one-half-acre area into a green, inviting Seattle Center entry. The new space, designed sustainably as a demonstration site for new materials, will serve to reinforce the identities of the two theaters, offering a mix of native plants and regionally adapted vegetation along terraced surfaces creatively lit in the evenings to evoke a moonlit garden. On-site raingardens will retain roof and site water run-off. Permeable pavers, trees and energy efficient streetlights will accommodate greater pedestrian movement through the space.

Theater Commons is an early project of the Seattle Center Century 21 Master Plan, which calls for major campus redevelopment to better serve community needs. Construction will begin in October 2009, with completion by May 2010.

All parking in the construction area will be eliminated as part of a long-term effort to increase campus open space by consolidating parking in garages at the edges of campus.

ADA parking capacity in Mercer Garage will be expanded to compensate for the loss of surface parking. Accessible pedestrian drop-off areas adjacent to the two theatres are available, and the Seattle Rep and Intiman are working directly with their theater patrons who have disabilities that cannot be accommodated by the Garage parking to determine how best to serve their specific needs. ADA-designated street parking will also be available along Warren and 2<sup>nd</sup> Avenues.

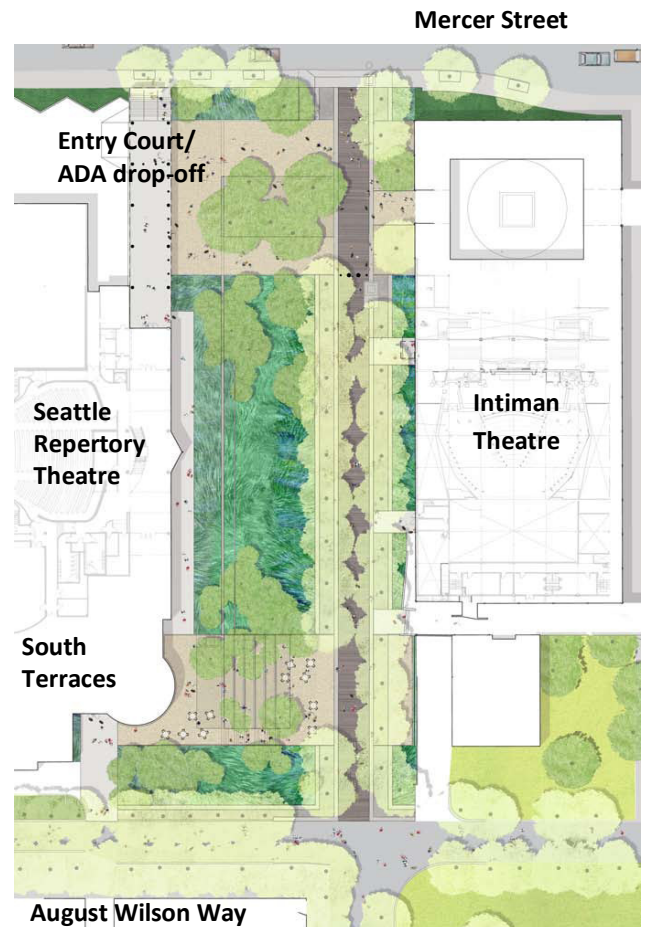

Theater Commons at Seattle Center fulfills a vision of creating a legible, welcoming north entry that sets the context and tone for a pleasing visitor experience at Seattle Center and the north entry theaters.

A major grant by the Kreielsheimer Foundation, matched by City of Seattle and private funding, made this project possible.

If you have questions or comments about Theater Commons at Seattle Center, please call 206.684.7117.

At left:  
**Donnelly Gardens at Theater Commons**